

PARTS LIST

Model 210/220 Exploded View

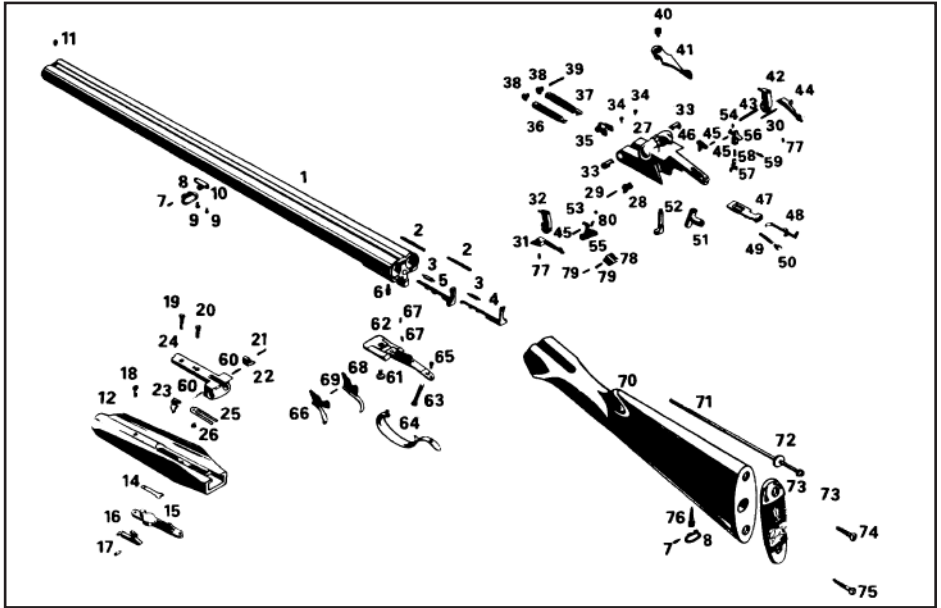

- | | | |
|-----------------------------|-----------------------------------|----------------------------|
| 1.barrel assembly | 29.cam pin | 55.safety |
| 2.extractor spring | 30.sear pin | 56.sear lifter lever |
| 3.plunger | 31.left sear | 57.sear lifter |
| 4.right extractor | 32.left hammer assembly | 58.sear lifter spring |
| 5.left extractor | 33.plug | 59.sear lifter level pin |
| 6.screw | 34.plug screw | 60.pin |
| 7.pin | 35.follower | 61.screw |
| 8.sling swivel ring | 36.left rod assembly | 62.trigger plate |
| 9.screw | 37.right rod assembly | 63.screw |
| 10.barrel sling swivel base | 38.cocking lever | 64.trigger guard |
| 11.front sight | 39.cocking lever pin | 65.trigger guard screw |
| 12.forend | 40.screw | 66.right trigger |
| 13.washer | 41.locking lever | 67.trigger spring |
| 14.spring | 42.right hammer assembly | 68.left trigger |
| 15.latch body | 43.hammer pin | 69.pin |
| 16.forend latch | 44.right sear | 70.stock |
| 17.pin | 45.pin for safety and thumb piece | 71.screw |
| 18.screw | 46.thumb piece | 72.washer |
| 19.screw | 47.locking bolt | 73.butt plate |
| 20.screw | 48.connecting rod | 74.woodscrew |
| 21.lever pin | 49.locking bolt spring | 75.woodscrew |
| 22.left lever | 50.cam stop | 76.stock sling swivel base |
| 23.right lever | 51.threaded connecting piece | 77.sear spring |
| 24.hinge | 52.locking bolt lever | 78.wright |
| 25.lever spring | 53.ball | 79.pin |
| 26.screw | 54.sear lifter lever spring | 80.safety spring |
| 27.receiver | | 81.bushing |

Model 210 with Single Trigger

Model 100

1. left sear
2. right sear
3. trigger
4. spring
5. selector plunger
6. selector
7. pin
8. weight
9. arm base spring
10. selector arm base
11. selector arm spring
12. selector arm pin
13. selector arm

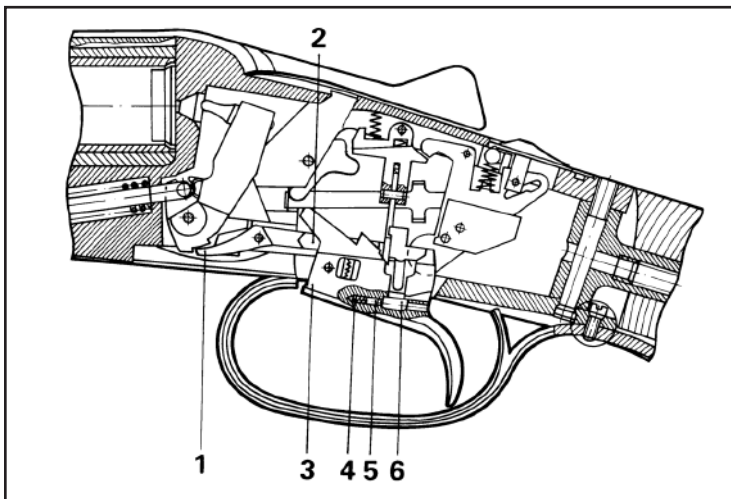

Firing mechanism of Model 220 shotgun 3-inch chamber version GA. 12, .410

Model 220

1. barrel assembly
2. receiver
3. firing pin
4. firing pin spring
5. firing pin bushing
6. left hammer
7. right hammer
8. firing pin buffer

