

MODEL 700™ ETRONX™

Bolt Action Centerfire Rifle

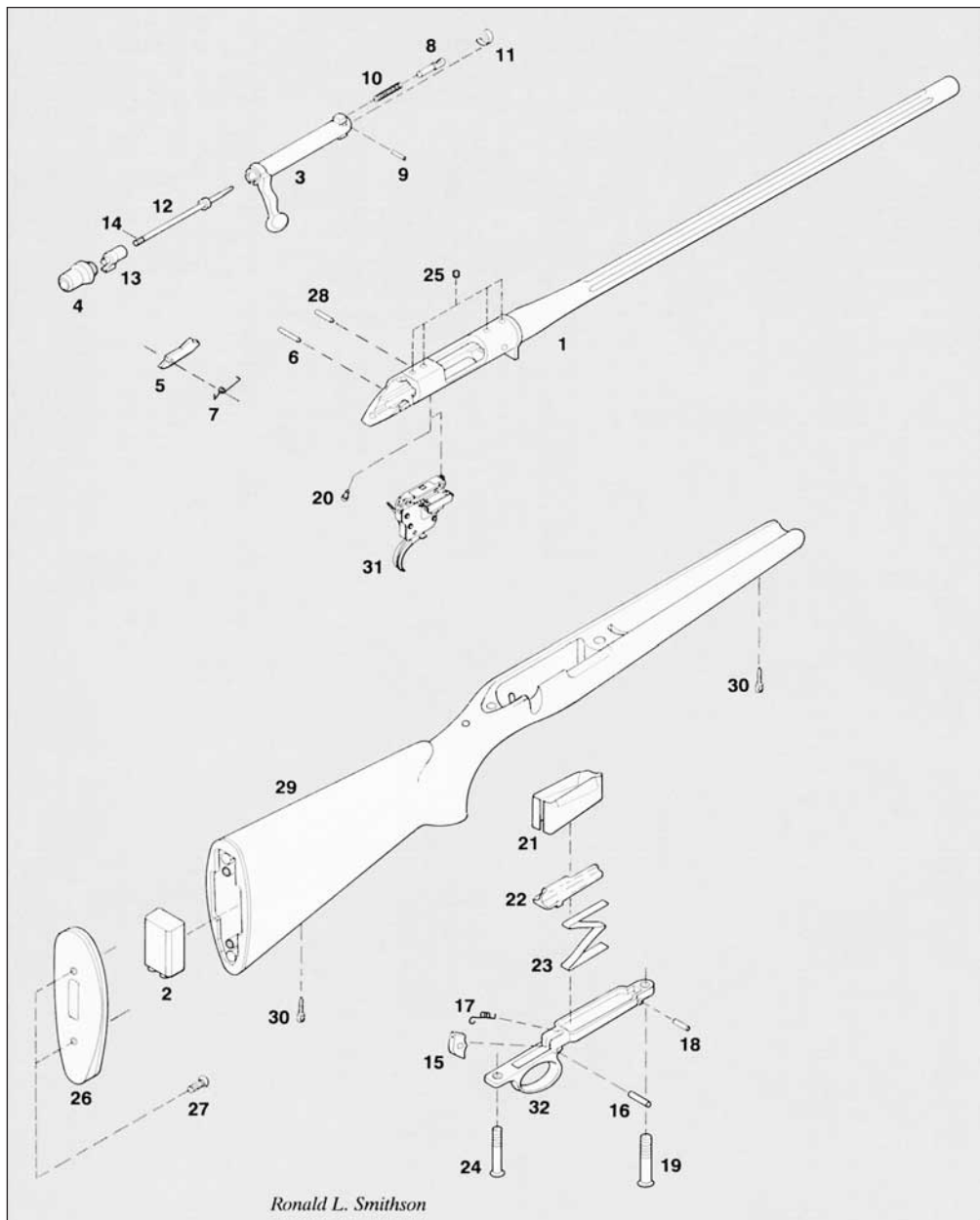

Ronald L. Smithson

MODEL 700™ ETRONX™

Bolt Action Centerfire Rifle

PARTS LIST

VIEW #	PART NAME
1	Barrel Assembly (Restricted)
2	Battery
3	Bolt Assembly (Restricted)
4	Bolt Plug Assembly (Restricted)
5	Bolt Stop (Restricted)
6	Bolt Stop Pin (Restricted)
7	Bolt Stop Spring (Restricted)
8	Ejector
9	Ejector Pin
10	Ejector Spring
11	Extractor
12	Firing Pin Assembly (Restricted)
13	Firing Pin Contact Assembly
14	Firing Pin Insulator
15	Floor Plate Latch
16	Floor Plate Latch Pin
17	Floor Plate Latch Spring
18	Floor Plate Pivot Pin
19	Front Guard Screw
20	Grounding Screw
21	Magazine
22	Magazine Follower
23	Magazine Spring
24	Rear Guard Screw
25	Receiver Plug Screw
26	Recoil Pad (Restricted)
27	Recoil Pad Screw
28	Sear Pin (Restricted)
29	Stock Assembly (Restricted)
30	Swivel Screw (2)
31	Trigger Assembly (Restricted)
32	Trigger Guard Assembly

WARNING: Before troubleshooting, check the chamber and the magazine to make sure there are no cartridges in the firearm.

TROUBLESHOOTING GUIDE

PROBLEM	POSSIBLE CAUSES	POSSIBLE SOLUTIONS
LED flashes 1 time.	<ul style="list-style-type: none"> • Low battery voltage. 	<ul style="list-style-type: none"> • Replace battery.
LED flashes 2 times.	<ul style="list-style-type: none"> • Battery is dead. 	<ul style="list-style-type: none"> • Replace battery.
LED flashes 3 times.	<ul style="list-style-type: none"> • Key switch in the OFF/DISABLED (0) position when safety mechanism moved from the S-SAFE to F-FIRE position. 	<ul style="list-style-type: none"> • Move safety mechanism from F-FIRE back to S-SAFE. Turn key switch to ON/ENABLE (I). Then move the safety mechanism back to the F-FIRE position.
LED flashes 4 times.	<ul style="list-style-type: none"> • Trigger pulled when safety mechanism was moved from S-SAFE to F-FIRE. 	<ul style="list-style-type: none"> • Cycle safety mechanism from F-FIRE to S-SAFE and then back to F-FIRE with your finger off the trigger.
		<ul style="list-style-type: none"> • Check for and relieve any binding of the trigger between mating components such as trigger guard.
		<ul style="list-style-type: none"> • Trigger switch is damaged. Factory service is required.
LED flashes 5 times.	<ul style="list-style-type: none"> • Battery was installed with the safety mechanism in the F-FIRE position. 	<ul style="list-style-type: none"> • Cycle safety mechanism from F-FIRE to S-SAFE and then back to F-FIRE with your finger off the trigger.
LED flashes 6, 7, 8, 9, 10 or 11 times.	<ul style="list-style-type: none"> • Malfunction in the on-board electronics. 	<ul style="list-style-type: none"> • Factory service is required. Do not attempt to use your firearm. Please note the number of flashes in the letter of explanation accompanying the firearm when it is returned for service.
Cartridge chambered but LED does not illuminate.	<ul style="list-style-type: none"> • Safety mechanism in S-SAFE position. 	<ul style="list-style-type: none"> • Move safety mechanism to F-FIRE position.
	<ul style="list-style-type: none"> • No battery in the firearm. 	<ul style="list-style-type: none"> • Unload the firearm following the instructions on page 14. Install the battery following the instructions on page 10.
	<ul style="list-style-type: none"> • Firing pin not touching the primer. 	<ul style="list-style-type: none"> • Firing pin is bound rearward. Unload the firearm following the instructions on page 14. Disassemble the bolt following the instructions on page 16 and verify the firing pin moves freely. If it does not, contact Remington® for service, noting the condition in the letter of explanation accompanying the firearm when it is returned for service. • Cartridge's primer contact is misaligned with the firing pin. Replace with a new cartridge. • Cartridge's primer contact is obstructed. Replace with a new cartridge.

WARNING: Before troubleshooting, check the chamber and the magazine to make sure there are no cartridges in the firearm.

TROUBLESHOOTING GUIDE (Continued)

PROBLEM	POSSIBLE CAUSES	POSSIBLE SOLUTIONS
Cartridge chambered but LED does not illuminate.	<ul style="list-style-type: none"> • Ammunition problem. 	<ul style="list-style-type: none"> • Replace with a new cartridge.
	<ul style="list-style-type: none"> • Battery installed with polarity reversed. 	<ul style="list-style-type: none"> • Unload the firearm following the instructions on page 14. Reinstall the battery following the instructions on page 10, paying close attention to the battery polarity (the large diameter terminal on the battery is the negative (-) terminal).
LED goes out when trigger is pulled, but cartridge does NOT fire.	<ul style="list-style-type: none"> • Firing pulse to round shorted. 	<ul style="list-style-type: none"> • Unload the firearm following the instructions on page 14. Disassemble and clean the bolt and firing pin following the instructions on page 16. Reassemble the bolt following the instructions on page 16.
		<ul style="list-style-type: none"> • With the bolt removed from the action, wipe the top of the trigger assembly with a clean cloth to remove any fouling or debris. Replace the bolt, reload and try firing the cartridge again.
		<ul style="list-style-type: none"> • With the bolt out of the action, move the safety mechanism from S-SAFE to F-FIRE. If the LED illuminates, return the firearm to the factory for service. Please note the condition in the letter of explanation accompanying the firearm when it is returned for service.
	<ul style="list-style-type: none"> • Ammunition problem. 	<ul style="list-style-type: none"> • Replace with a new cartridge.
	<ul style="list-style-type: none"> • Firing pin insulator missing. 	<ul style="list-style-type: none"> • Unload the firearm following the instructions on page 14. Disassemble the bolt and firing pin following the instructions on page 16. Verify the firing pin insulator is installed on the rear of the firing pin. Replace the firing pin insulator if it is missing. Reassemble the firing pin and bolt following the instructions on page 16.
<ul style="list-style-type: none"> • Firing pin is damaged. 	<ul style="list-style-type: none"> • Return the firearm to the factory for service. Please note the condition in the letter accompanying the firearm when it is returned for service. 	

WARNING: Before troubleshooting, check the chamber and the magazine to make sure there are no cartridges in the firearm.

TROUBLESHOOTING GUIDE (Continued)

PROBLEM	POSSIBLE CAUSES	POSSIBLE SOLUTIONS
LED turns ON solid when bolt is closed on empty chamber.	<ul style="list-style-type: none"> Firing circuit is shortened. 	<ul style="list-style-type: none"> Bolt and/or firing pin assembly is fouled. Unload the firearm following the instructions on page 14. Disassemble and clean the bolt and firing pin following the instructions on page 16. Reassemble the bolt following the instructions on page 16.
	<ul style="list-style-type: none"> Firing pin insulator missing. 	<ul style="list-style-type: none"> Unload the firearm following the instructions on page 14. Disassemble the bolt and firing pin following the instructions on page 16. Verify the firing pin insulator is installed on the rear of the firing pin. Replace the firing pin insulator if it is missing. Reassemble the firing pin and bolt following the instructions on page 16.
	<ul style="list-style-type: none"> Firing pin is damaged. 	<ul style="list-style-type: none"> Return the firearm to the factory for service. Please note the condition in the letter of explanation accompanying the firearm when it is returned for service.
LED turns ON solid or flickers when bolt is moved.	<ul style="list-style-type: none"> Bolt touching trigger assembly contact. 	<ul style="list-style-type: none"> Lift the bolt handle and pull the bolt partway back. If the LED flickers when the bolt is moved, return the firearm to the factory for service. Please note the condition in the letter of explanation accompanying the firearm when it is returned for service.
LED turns ON solid when bolt is open.	<ul style="list-style-type: none"> Bolt touching trigger assembly contact. 	<ul style="list-style-type: none"> With the bolt out of the action, move the safety mechanism from S-SAFE to F-FIRE. If the LED illuminates, return the firearm to the factory for service. Please note the condition in the letter of explanation accompanying the firearm when it is returned for service.
LED turned ON solid when bolt is out of the firearm.	<ul style="list-style-type: none"> Firing circuit is shorted. 	<ul style="list-style-type: none"> Factory service is required. Please note the condition in the letter of explanation accompanying the firearm when it is returned for service.
LED turned ON solid with the safety mechanism in the S-SAFE position.	<ul style="list-style-type: none"> Electronics or cabling failure. 	<ul style="list-style-type: none"> Factory service is required. Please note the condition in the letter of explanation accompanying the firearm when it is returned for service.