

PARTS LIST

Model 210/220 Exploded View

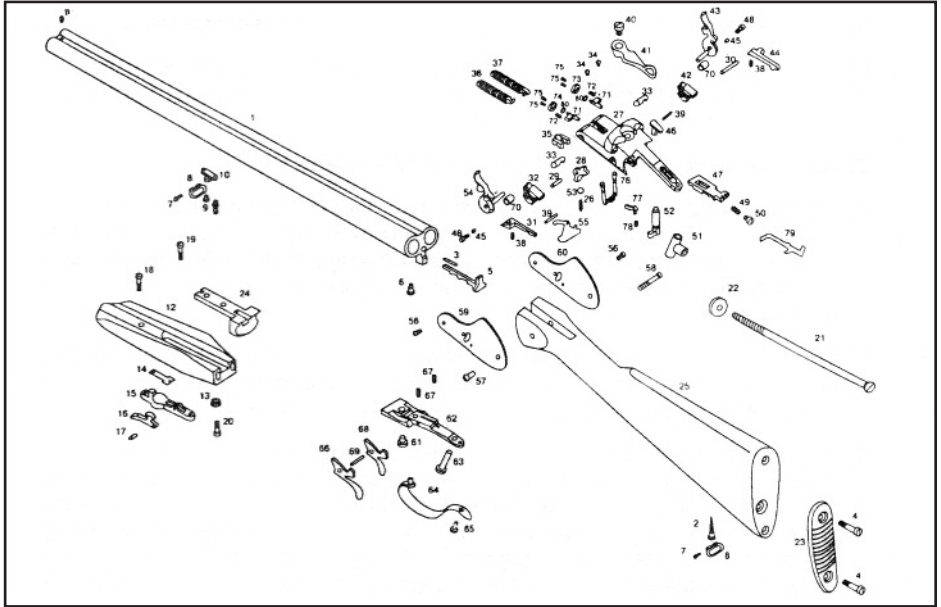

- | | | |
|------------------------|---------------------------|------------------------------|
| 1. barrel assembly | 29. cam pin | 55. safety |
| 2. stock swivel base | 30. sear pin | 56. screw |
| 3. extractor pin | 31. sear, LH | 57. bush |
| 4. woodscrew | 32. left hammer base | 58. screw |
| 5. extractor | 33. plug | 59. plate, LH |
| 6. screw | 34. plug screw | 60. plate, RH |
| 7. swivel pin | 35. follower | 61. screw |
| 8. swivel loop | 36. rod assembly, LH | 62. trigger plate |
| 9. screw | 37. rod assembly, RH | 63. screw |
| 10. barrel swivel base | 38. spring | 64. trigger guard |
| 11. front sight | 39. safety pin and button | 65. trigger guard screw |
| 12. forend | 40. screw | 66. trigger, LH |
| 13. forend bush | 41. locking lever | 67. trigger spring |
| 14. spring | 42. right hammer base | 68. trigger, RH |
| 15. catch housing | 43. hammer, RH | 69. pin |
| 16. forend catch | 44. sear, RH | 70. hammer bush |
| 17. pin | 45. screw | 71. firing pin |
| 18. screw | 46. button | 72. firing pin spring |
| 19. screw | 47. locking bolt | 73. firing pin bushing, RH |
| 20. screw | 48. screw | 74. firing pin bushing, LH |
| 21. screw | 49. locking bolt screw | 75. firing pin bushing screw |
| 22. washer | 50. cam stop | 76. blocking frame |
| 23. butt plate | 51. crosspiece | 77. blocking lever |
| 24. hinge | 52. locking bolt lever | 78. blocking lever spring |
| 25. stock | 53. ball | 79. connecting rod |
| 26. safety spring | 54. hammer, LH | 80. shock-absorber |
| 27. receiver | | 81. bushing |
| 28. cam | | |