

# MODEL 300™

# OVER & UNDER SHOTGUN

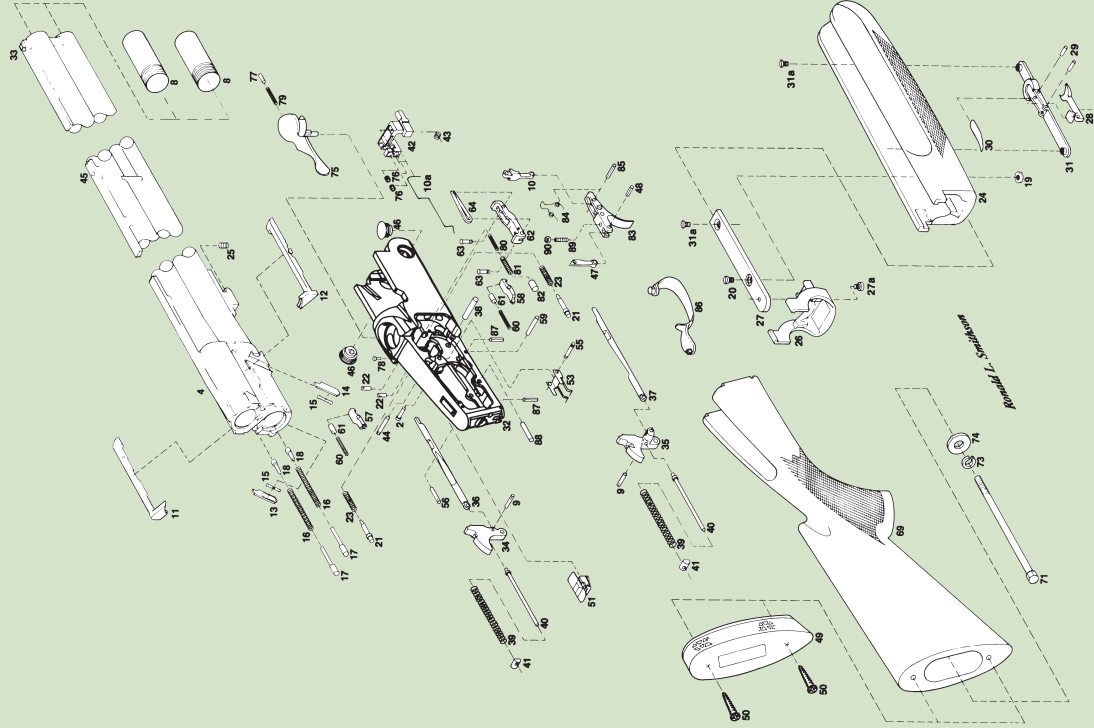

View No.	Part Name	View No.	Part Name
	<b>NOTE: Field Grade listed below.</b>	32	Frame (Restricted)
4	Barrel Assembly (Restricted)	33	Front Sight
8	Choke Tube – See Accessories	34	Hammer – Left
9	Cocking Rod Retaining Pin (2)	35	Hammer – Right
10	Connector	36	Hammer Cocking Rod – Left
10 a	Disconnecter Rod (Restricted)	37	Hammer Cocking Rod – Right
11	Ejector – Left (Restricted)	38	Hammer Pivot Pin
12	Ejector – Right (Restricted)	39	Hammer Spring (2)
13	Ejector Sear – Left (Restricted)	40	Hammer Spring Plunger (2)
14	Ejector Sear – Right (Restricted)	41	Hammer Spring Plunger Pivot (2)
15	Ejector Sear Spring (2)	42	Locking Bolt (Restricted)
16	Ejector Spring (2)	43	Locking Bolt Spring
17	Ejector Spring Plunger (2)	44	Locking Bolt Spring Pivot
18	Ejector Spring Retainer (2)	45	Middle Sight
19	Escutcheon	46	Pivot Pin (2)
20	Escutcheon Screw	47	Rear Connector Link
21	Firing Pin (2)	48	Rear Connector Link Pin
22	Firing Pin Retaining Pin (2)	49	Recoil Pad
23	Firing Pin Spring (2)	50	Recoil Pad Screw (2)
24	Fore–End (Field)	51	Safety/Barrel Selector Assembly
25	Fore–End Adjusting Screw	53	Safety Detent Spring
26	Fore–End Iron (Restricted)	55	Safety Spring Retaining Pin
27	Fore–End Iron Beam	56	Safety Stop Pin
27 a	Fore–End Iron Beam Screw	57	Sear – Left
28	Fore–End Latch	58	Sear – Right
29	Fore–End Latch Pivot/Stop Pin (2)	59	Sear Pivot Pin
30	Fore–End Latch Spring	60	Sear Spring (2)
31	Fore–End Latch Plate	61	Sear Spring Plunger (2)
31 a	Fore–End Latch Plate Screw (2)		

View No.	Part Name	Part No.	Part Name
62	Selector Block		Accessories
63	Selector Block Pin (2)	94525	Choke Tube Wrench
64	Selector Block Pin Retaining		Choke Tubes – Full, Imp. Cyl. & Mod.
69	Stock Assembly (Field)		Additional Choke Tubes Available
71	Stock Bolt		
73	Stock Bolt Lock Washer	102915	Trap Full
74	Stock Bolt Washer	102916	Trap Extra Full
75	Top Lever	102917	Trap Super Full
76	Top Lever Adjusting Screw (2)	100890	Full
77	Top Lever Detent	100891	Imp. Cyl.
78	Top Lever Detent Plunger	100892	Mod.
79	Top Lever Detent Spring	100893	Imp. Mod.
80	Top Lever Spring – Inner	100894	Skeet
81	Top lever Spring – Outer	93936	Imp. Skeet
82	Top Lever Spring Plunger	94501	Rifled
83	Trigger		NOTE: The firearm must be returned to the factory or a Remington Authorized Gunsmith to assure proper fit of restricted parts.
84	Trigger Connector Spring		
85	Trigger Connector Spring Pin		
86	Trigger Guard		
87	Trigger Guard Pin		
88	Trigger Pivot Pin		
89	Trigger Screw		
90	Trigger Screw Nut		