

PARTS LIST

Premier® Over and Under Shotgun Exploded View

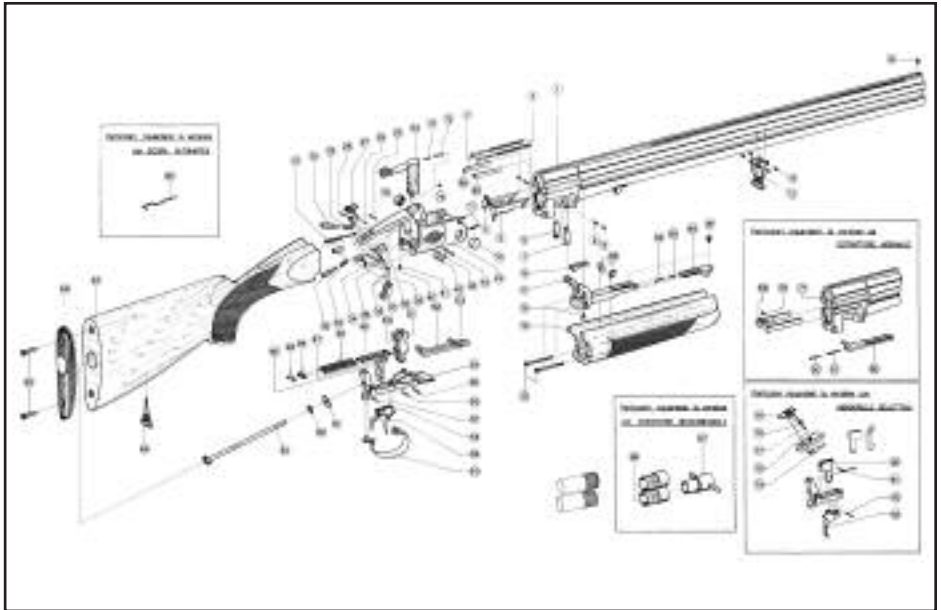

List of Premier® Over and Under Components

- | | | | |
|-----------------------------------|--------------------------------------|-----------------------------|----------------------------------|
| 1. barrels | 29. firing pin spring | 54. trigger plate | 79. single trigger safety spring |
| 2. ejector spring | 30. lower firing pin | 55. hammer pin | 80. inertia block |
| 3. ejector spring guide | 31. top lever spring | 56. trigger pin | 81. inertia block spring |
| 4. left ejector | 32. upper firing pin | 57. trigger guard stop pin | 82. single trigger pin |
| 5. right ejector | 33. firing pin spring | 58. right trigger | 83. single trigger |
| 6. left ejector catch-plate | 34. locking bolt | 59. left trigger | 84. forearm catch spring |
| 7. right ejector catch-plate | 35. safety spring | 60. trigger guard | 85. forearm catch spring guide |
| 8. catch-plate stop piston spring | 36. sear spring | 61. stock bolt washer | 86. forearm catch |
| 9. catch-plate stop piston | 37. sear | 62. stock bolt lock washer | 87. forearm catch screw |
| 10. joint pin | 38. safety plate | 63. stock bolt | 88. left ejector hammer |
| 11. joint pin stop pin | 39. top lever spring guide (outside) | 64. stock sling swivel | 89. cocking bar spring guide |
| 12. front sling swivel | 40. top lever spring guide (inside) | 65. butt plate screws | 91. cocking bar spring |
| 13. sling swivel screw | 41. top lever spring contrast screw | 66. butt plate | 92. cocking bar |
| 14. front sight | 42. trigger plate assembling pin | 67. stock | 93. hammer spring guides nut |
| 15. fore-end hinge screw | 43. top lever stop pin | 68. automatic safety bar | 94. hammer spring guide washer |
| 16. cocking hook | 44. firing pin stop pin | 69. extractor | 95. fore-end nut |
| 17. fore-end iron | 45. receiver | 70. extractor stop screw | 96. choke tube |
| 18. cocking hook screw | 46. right trigger plate | 71. barrels | 97. choke tube |
| 19. forearm wood | 47. left trigger plate | | |
| 24. top lever | 48. hammers spring | | |
| 25. sears pin | 49. hammer spring guide | | |
| 26. safety spring pin | 50. left hammer | | |
| 27. safety button | 51. right hammer | | |
| 28. strap screw | 52. right cocking bar | | |
| | 53. left cocking bar | | |
| | | 54. trigger plate | |
| | | 55. hammer pin | |
| | | 56. trigger pin | |
| | | 57. trigger guard stop pin | |
| | | 58. right trigger | |
| | | 59. left trigger | |
| | | 60. trigger guard | |
| | | 61. stock bolt washer | |
| | | 62. stock bolt lock washer | |
| | | 63. stock bolt | |
| | | 64. stock sling swivel | |
| | | 65. butt plate screws | |
| | | 66. butt plate | |
| | | 67. stock | |
| | | 68. automatic safety bar | |
| | | 69. extractor | |
| | | 70. extractor stop screw | |
| | | 71. barrels | |
| | | 72. top level stop spring | |
| | | 73. top lever stop pin | |
| | | 74. top lever releasing pin | |
| | | 75. single trigger safety | |
| | | 76. safety block | |
| | | 77. block spring | |
| | | 78. safety position ball | |